

ISS	AMEND	DATE
1	1st DRAWN	26/03/09

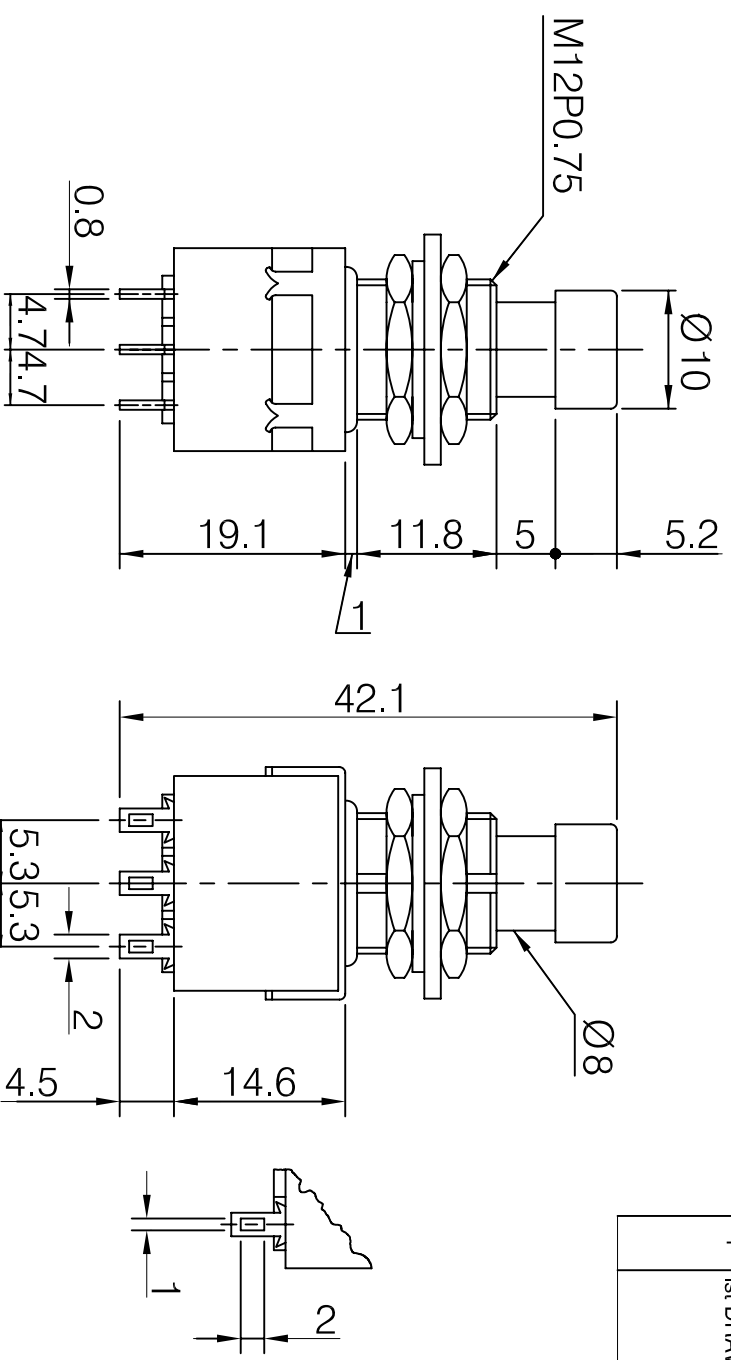

**SPECIFICATION**

1. Rating : AC 125V 4A 250V 2A.
2. Contact R. : 20M $\Omega$  Max.
3. Insulation R. : DC 500V 100M $\Omega$  Min.
4. Dielectric Strength : AC 1500V 1 minute
5. Electrical Life : 20.000 make-and-break cycles at full load.

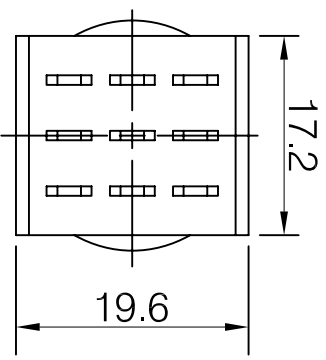

**RoHS**  
**COMPLIANT**

**Tolerance**  
 NO DEC. PLACE  $\pm 0.20$   
 1 DEC. PLACE  $\pm 0.20$   
 2 DEC. PLACE  $\pm$   
 DIA. HOLES  $\pm 0.20$   
 ANGLES  $\pm 1/2^\circ$   
 UNLESS  
 OTHERWISE STATED

DIMENSIONS IN MILLIMETERS UNLESS OTHERWISE STATED. WORK TO DIMENSIONS. DO NOT SCALE DRAWING. 3rd ANGLE PROJECTION. REMOVE BURRS. IF IN DOUBT ASK. SCALE N.T.S.

**CLIFF**

MATERIAL: COMPOSITE  
 FINISH: AS MOULDED  
 DRAWN: XHZ

TITLE: 3 POLE FOOTSWITCH 3 PDT  
 APPD : PCS

DRWG NO : FC71078  
 FORM:A4DRWGH