

| ISS | AMEND | DATE |
|-----|-----------|----------|
| 1 | 1st DRAWN | 26/03/09 |

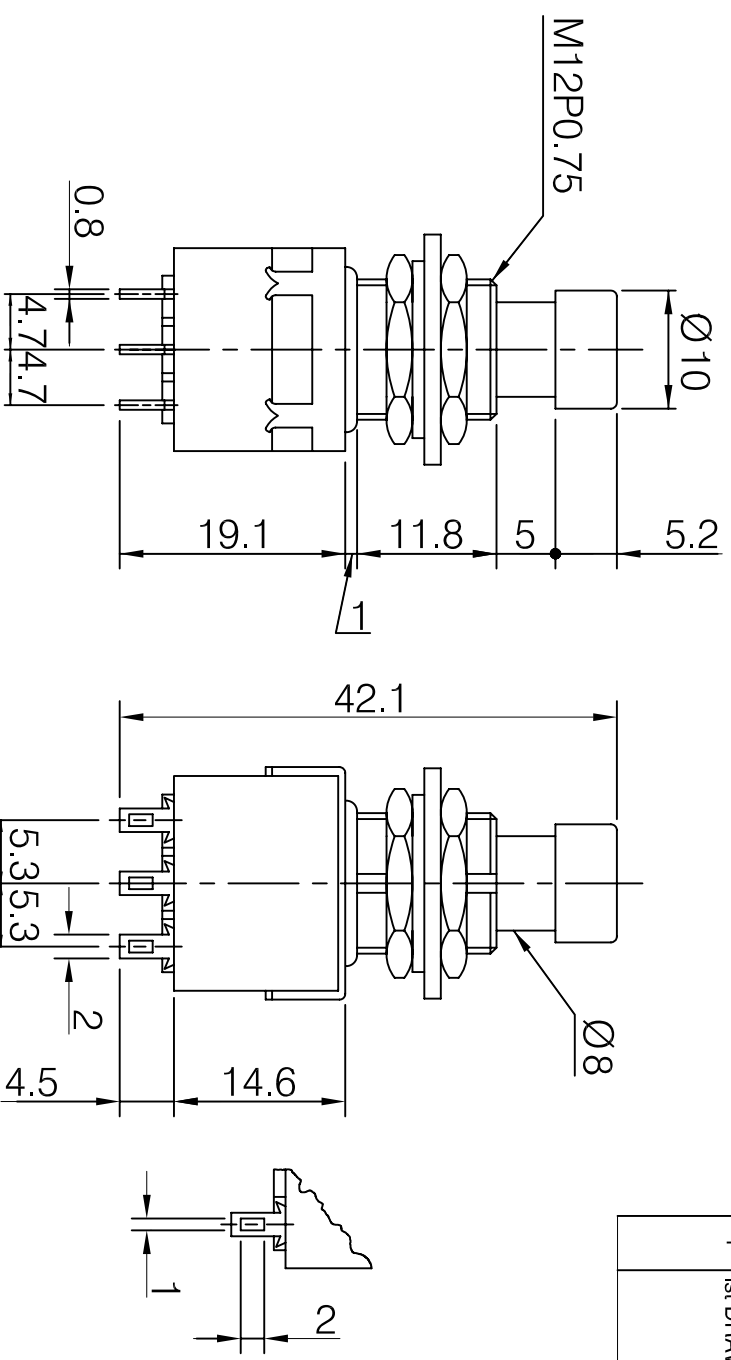

SPECIFICATION

1. Rating : AC 125V 4A 250V 2A.
2. Contact R. : 20MΩ Max.
3. Insulation R. : DC 500V 100MΩ Min.
4. Dielectric Strength : AC 1500V 1 minute
5. Electrical Life : 20.000 make-and-break cycles at full load.

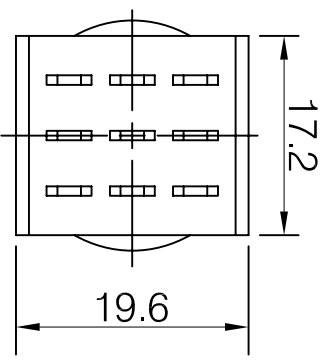

DIMENSIONS IN MILLIMETERS UNLESS OTHERWISE STATED. WORK TO DIMENSIONS. DO NOT SCALE DRAWING. 3rd ANGLE PROJECTION. REMOVE BURRS. IF IN DOUBT ASK.

CLIFF

MATERIAL: COMPOSITE
FINISH: AS MOULDED
DRAWN: XHZ

APPD : PCS

TITLE: 3 POLE FOOTSWITCH 3 PDT
DRWG NO : FC71077

FORM:A4DRWGH

| |
|--|
| <p>Tolerance NO DEC. PLACE ±0.20 1 DEC. PLACE ±0.20 2 DEC. PLACE ± DIA. HOLES ±0.20 ANGLES ±1/2° UNLESS OTHERWISE STATED WHERE USED F.R. SCALE N.T.S.</p> |
|--|