

# Instrument Control Knobs

We produce a versatile range of knobs designed to enhance the appearance - functionality of any equipment to which they are fitted. Knobs are made to high standards of finish in order to satisfy the users most exacting requirements.

All models are moulded in black Nylon, ABS or PP. Some models can be supplied in white or grey colors. Other custom made colors are produced subject to reasonable order quantity. (Sometimes setup charges are required). Some models can accept optional diamond spun caps or colored caps. Marker dots are standard on models as indicated. The standard dot (or line) position is opposite to the set screw or 'D' flat. Other variants are possible subject to our agreement. Refer to table on Page 8. for details of shaft sizes available.

Collet fitting using our low cost plastic collet system is available for K9 - K12 series.

2 color moulded models K85M, K87MA, K87MB are suitable for mixing consoles. They combine good looks and ultimate low cost. Some models are available with rubber "Soft Touch" finish,  indicates 2 color moulded.

Applications requiring similar style knobs of various sizes are well catered for in our range of models.

When ordering - specify Quantity, Model, Color, Fixing, Lines or Dots, Shaft size. If in doubt, refer to our Sales Office.

Example : K6 / black / SF / Marker dot / 1/4" - or - K9 / black / marker line / 6mm. splined.

## K1, K2

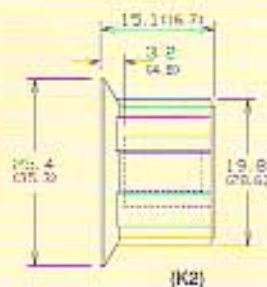

Practical low cost knobs. Often used in outdoors equipment. Chrome, Satin or colored discs available. Marker dot on skirt is standard.  
K1 - Packed 200 / bag.  
K2 - Packed 100 / bag.

## K3, K4

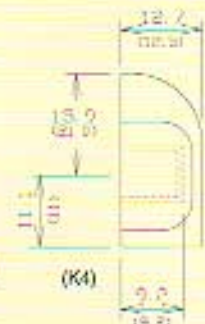

Pointer knobs with a matt textured finish. Marker line version is available.  
K3, K4 - Packed 500 / bag.

See Page 8 for Shaft Options available.

## K5, K6, K6/SKT



K5 - Marker line on top is optional (100 / box)  
K6 - Screw fix only. Dot on top is optional (200 / box)  
K6/SKT - Standard skirts are: Plain, 0-5-0 or 0-10.  
Packed 200 / carton.

## K7, K8

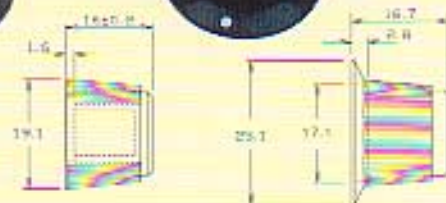

K7 - Marker line on top is optional.  
K8 - Marker dot on skirt is standard.  
Note: Both models can have a colored plastic top (Min 1000)

# ORDERING INFORMATION

## STANDARD COLOURS

The colours shown below are for reference only and may not be identical to actual colours. If exact colour selection is required, we would be happy to provide samples for your evaluation.



In addition to the above, custom colours are available for single & multi colour moulded knobs. Call us to discuss your specific requirements.

Knob caps can be supplied plain, with a marker line (ML), with a marker dot (MD), or custom legend.

## SHAFT SIZES

When specifying fixing options below, indicate shaft size and type, i.e.: screw fix (SF), push fix ('D'), splined (SPL), or collet.

SHAFT SIZE	3mm.	4mm.	4mm.	4mm.	6mm.	6mm.	6mm. U.S.A.	6mm.	6mm.	1/4 inch.	1/4 inch.	1/4 inch.	1/4 inch.	MARKER NOT ALL FIX OPTIONS
KNOB TYPE														
K1				●	●				●	●		●		S (std)
K2				●					●	●		●		S (std)
K3, K4									●	●		●		Z
K5					●				●	●		●		Z
K6, K6/SKT				●		○			●	●		●		D SL N
K7				●	●	○			●	●		●		Z
K8				●					●	●		●		S (std)
K85, K85M, K85MS**		●			●	●	●			●	●			Z (std)
K87MA, K87MB+		○			●	●	●			●	●			LZ
K9*	●		●	●	●	●	●	●	●	●		●	●	LDZ
K10*	●		●	●	●	●	●	●	●	●		●	●	LDZ
K11	●		●	●	●	●	●	●	●	●		●	●	LDZ
K12	●		●	●	●	●	●	●	●	●		●	●	LDZ
K13 REFER TO DATA														
K14				●	●		K14P		●	●		●		Z
K15, K15P				●	●				●	●		●		K15 - Z
K16, K16P				●	●	○	K16P		●	●		●		K16 - Z
K17						○		○	○	○		●		Z (std)
C18, C18/SKT					●	●	●			●				C18 - Z part C18-SKT SL N
KM12B, KM15B					●									
K20B, K40B, K50B					●									
KMR Series					●					KMR40D				
KEY					● = AVAILABLE - STD		○ = ENQUIRE IF REQD.							1 Body line 2 Cap dot 3 Cap dot 4 Cap line 5 Cap line 6 Standard

\* For All Black model only - version with integral cap is available. NOT ALL PUSH FIX MODELS HAVE METAL SPRINGS.

+ Including 'R' 'Soft Touch' versions.

\*\* K85MS is under development.

Some models of our knobs are stocked by some Cliff distributors. Please enquire to our Sales Office.

© CLIFF 07/97

## Cliff Electronic Components Inc.

4876 EAST SECOND STREET,  
BENICIA, CA 94510 U.S.A.

Tel: (707) 746 8090 Fax: (707) 746 8092 E-Mail: cliff@crl.com

Website: <http://www.cliffcomponents.com>

