

CLIFF

CLIFFCON® S CONNECTORS 4 AND 8 POLE

The Cliffcon® S range is designed for audio applications. Also available are 4 and 8 pole standard Cliffcon® designed for power applications.



Cliffcon S
4 Pole plug with PVC Cable Grommet
Blue nut is standard.
Dimensions: 29 x 28 x 93mm

Part No. FM1245



Cliffcon S
4 Pole plug without PVC Cable Grommet
Blue nut is standard.
Dimensions: 29 x 28 x 68mm

Part No. FM1250



Cliffcon S
4 Pole Cable Socket with PVC Cable Grommet
Blue nut is standard.
Dimensions: 28 x 28 x 93mm

Part No. FM1255



Cliffcon S
8 Pole plug without PVC Cable Grommet
Blue nut is standard.
Dimensions: 35 x 35 x 85mm

Part No. FM1260

Plug Specification

Maximum Current:	20A.	Solderability:	≤ 3S
Withstanding Voltage:	≥1400V	Insertion Force:	10-80N
Insulation Resistance:	≥ 1GΩ	Minimum Life:	≥2000
Contact Resistance:	≤ 3mΩ		

Cliff Electronic Components, Ltd.

76 Holmethorpe Avenue, Holmethorpe Ind. Est.

Redhill, Surrey RH1 2PF. England

Tel: +44 (0) 1737 771375

Fax: +44 (0) 1737 766012

Email: sales@cliffuk.co.uk



Visit us online at:

www.cliffuk.co.uk



Cliffcon S
4 Pole Chassis Socket
Compatible with all Cliffcon S 4 Pole Plugs
Dimensions: 26 x 31 x 33mm

Part No: FM1270 with CSK Hole
FM1270X with Plain Hole

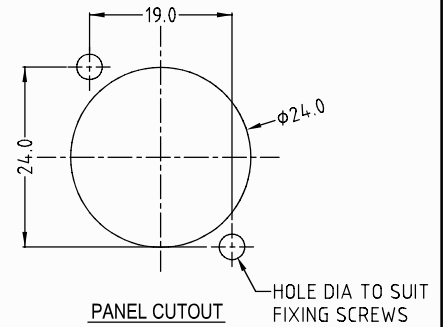

Cliffcon S
4 Pole Chassis Socket (Large Square Type)
Compatible with all Cliffcon S 4 Pole Plugs
Dimensions: 40 x 40 x 33mm

Part No: FM1275

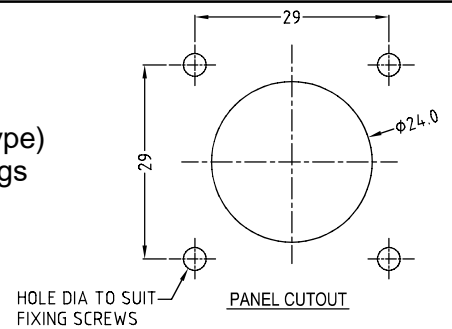

Cliffcon S
4 Pole Chassis Socket (Round Type)
Compatible with all Cliffcon S 4 Pole Plugs
Dimensions: 50 x 50 x 33mm

Part No: FM1280

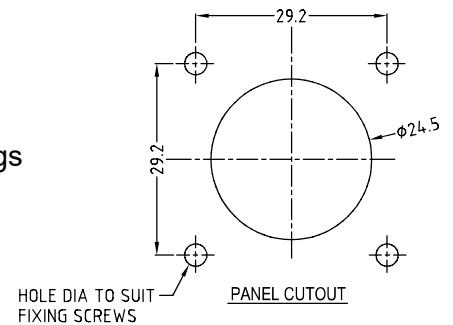

Cliffcon S
8 Pole Chassis Socket (Round Type)
Dimensions: 51 x 51 x 33mm

Part No: FM1285

